

Centrifugal Pump

Performance Chart

Model	Power		Q	US GPM	0	7	13	20	26	33	40	46	53	59	63	73	79	86	92	99	106	112	119	123	129
	KW	HP		M ³ /HR	0	1.5	3	4.5	6	7.5	9	10.5	12	13.5	15	16.5	18	19.5	21	22.5	24	25.5	27	28	29.5
				LPM	0	25	50	75	100	125	150	175	200	225	250	275	300	325	350	375	400	425	450	475	500
TECH-CP15A	1.1	1.5	H Meters	20	19	18	17	16	15	14	13	12	11	10	9	8	7	6	5	4	3	2			
TECH-CP20A & TECH-CP20AT	1.5	2		23	22	21	20	19	18	17	16	15	14	13	12	11	10	9	8	7	6	5	4	3	
TECH-CP30A & TECH-CP30AT	2.2	3		32	31	30	29	28	27	26	25	24	23	22	21	20	19	18	17	16	15	14	13	12	

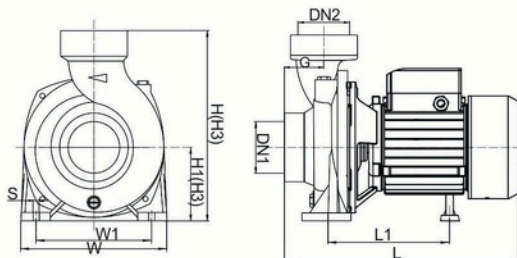
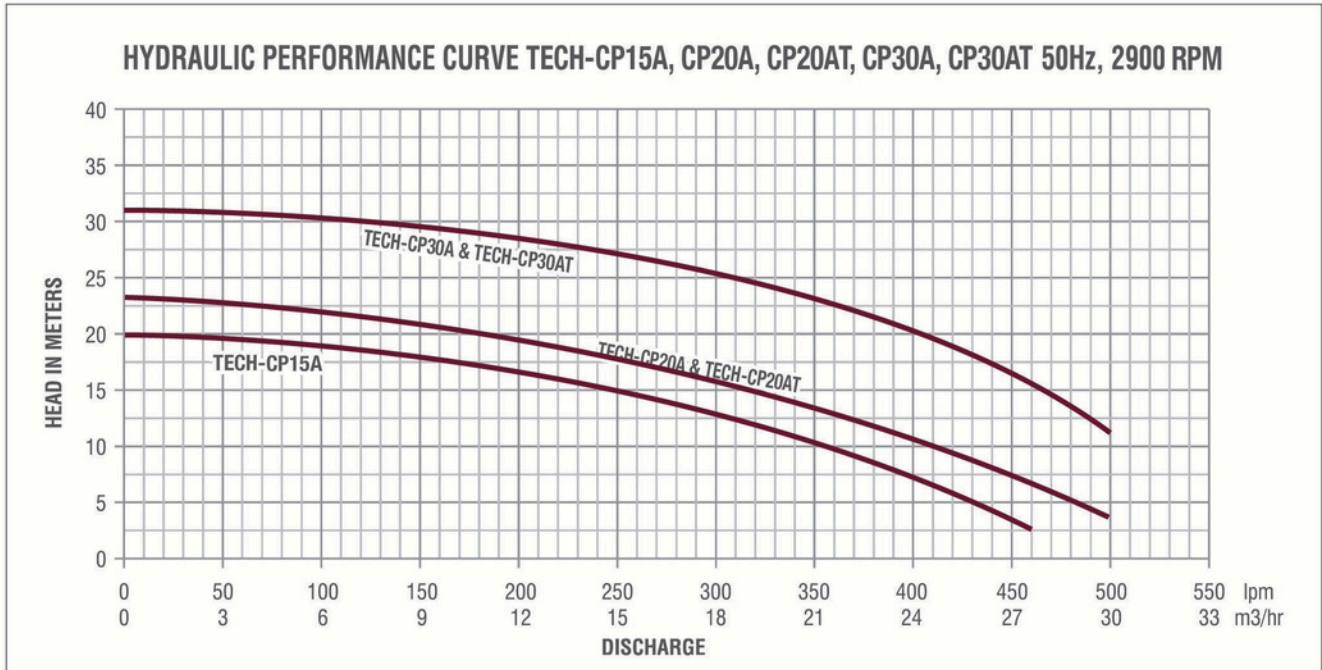

Dimension

Model	Inlet / Outlet		Dimension (mm)									
	DN1	DN2	L	L1	W	W1	H	H1	H2	H3	G	S
TECH-CP30	3"	3"	428	265	240	188	311	121	311	121	68	11
TECH-CP30T	3"	3"	428	265	240	188	311	121	311	121	68	11

Pump Selection Chart

Model	Power		Phase	Inlet / Outlet	Max. Flow (lpm)	Max. Head (m)	Max. Suction (m)
	KW	HP					
TECH-CP30	2.2	3	1Phase	3" x 3"	1100	18	8
TECH-CP30T	2.2	3	3Phase	3" x 3"	1100	18	8

Centrifugal Pump

Performance Chart

Model	Power		Q	US GPM	0	26	53	79	106	132	159	185	211	238	264	291
	KW	HP		M ³ /HR	0	6	12	18	24	30	36	42	48	54	60	66
				LPM	0	100	200	300	400	500	600	700	800	900	1000	1100
TECH-CP30	2.2	3	H Meters	18	17	16	15	14	13	12	11	10	09	08	07	
TECH-CP30T	2.2	3		18	17	16	15	14	13	12	11	10	09	08	07	

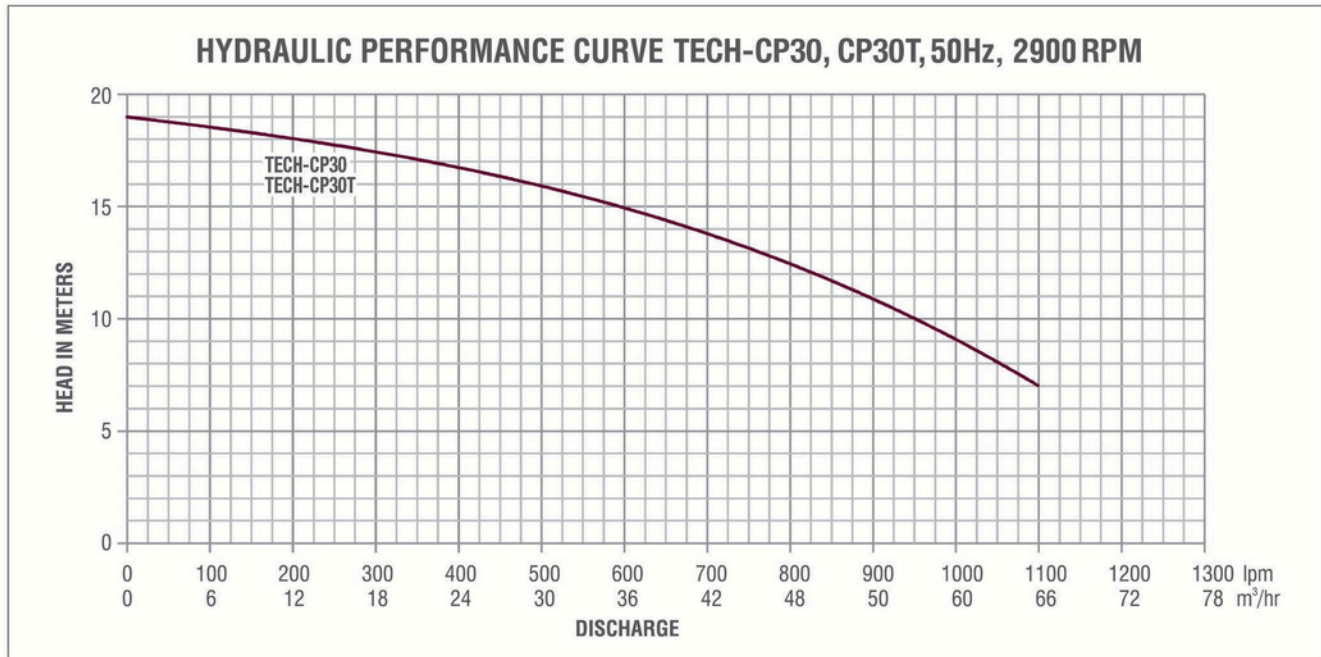

STAINLESS STEEL CENTRIFUGAL PUMP

Applications

This series is suitable for transporting clean media which are non-Abrasive to stainless steel 316

- Water Supply System
- Pressure boiler feeding
- Pure water treating systems
- Refining & chemical industries
- Washing & Sprinkling
- R.O plant

Application limits

- Suction Size : G1 ¼"
- Discharge Size : G1"
- Max. Working Pressure : 6 Bar
- Liquid Temp. : Up to 90°C
- To avoid overload & danger the pump should be operated within the performance ranges
- Altitude : <1000m

Product feature

Compact & nice in appearance while being efficient and low in voice. Our pumps have reliable seal and anti-heat ball bearing which results in case of maintenance and use.

Standard Material

- Pump impeller, Pump Body & Pump Cover : SS316
- Shaft : Friction welded 316
- Bearing : High loaded bearing
- Mechanical Seal : SIC/VITON/SS316

Performance Range

- Flow : Up to 10m³/hr
- Head : Up to 34 Meter
- Power : 0.75KW to 1.5KW
- Speed : 2900 RPM

Motor details

- T.E.F.C. Continuous duty insulation class : F
- Protection Class : IP55
- Ambient Temperature range : Up to 40°C
- Single Phase Version : 220v-240v, 50Hz
- Three Phase Version : 380v-420v, 50Hz
- 2 Pole induction motor
- Thermal overload protector in single phase motor
- Anti-heat ball bearing
- Environment temperature capacity 65°C
- Motor winding: 100% copper