

# Centrifugal Pump

## Performance Chart

Model	Power		Q	US GPM	0	3	5	8	11	13	16	18	21	24	26	29	32	34	37	40
	KW	HP		M <sup>3</sup> /HR	0	0.6	1.2	1.8	2.4	3	3.6	4.2	4.8	5.4	6	6.6	7.2	7.8	8.4	9
				LPM	0	10	20	30	40	50	60	70	80	90	100	110	120	130	140	150
TECH-CP10	0.75	1	H Meters	34	33	32	31	30	29	28	27	26	25	24	23	20				
TECH-CP15	1.1	1.5		36	35	34	33	32	31	30	29	28	27	26	25	24	23	22	21	

**HYDRAULIC PERFORMANCE CURVE TECH-CP10,CP15 50Hz, 2900 RPM**

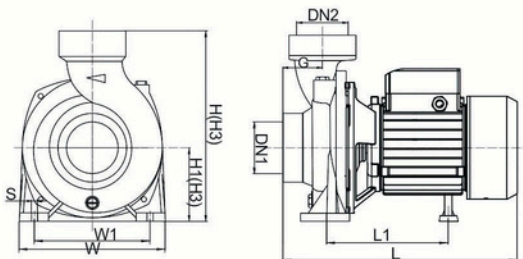
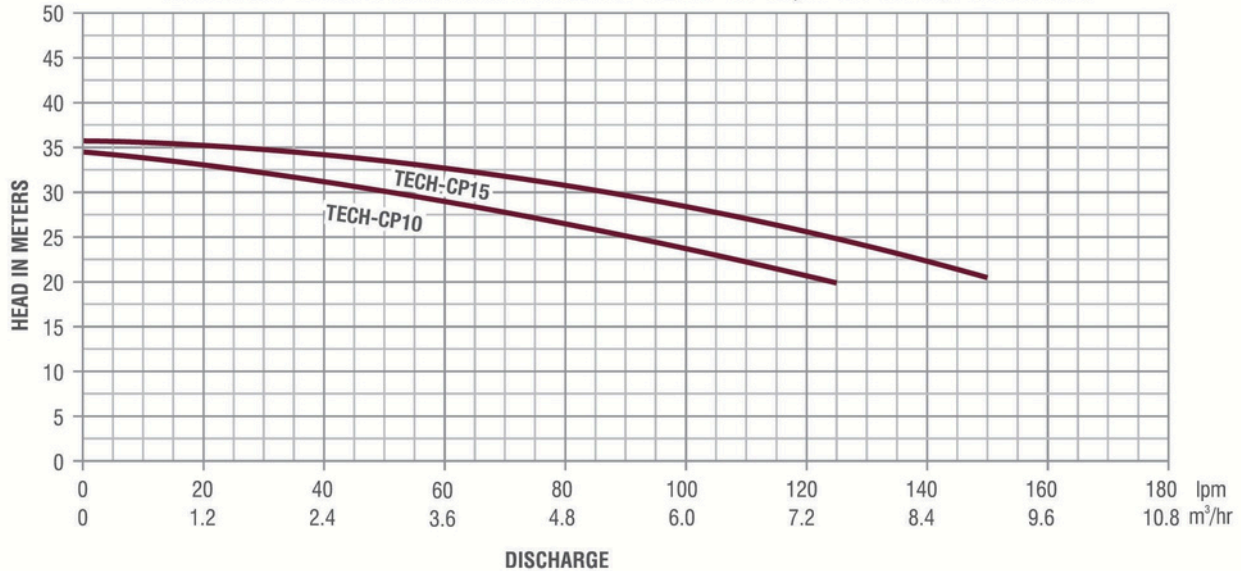

## Dimension

Model	Inlet / Outlet		Dimension(mm)										
	DN1	DN2	L	L1	W	W1	H	H1	H2	H3	G	S	
TECH-CP15A	2"	2"	370	225	207	157	258	108	258	108	152	8	
TECH-CP20A	2"	2"	370	225	207	157	258	108	258	108	152	8	
TECH-CP20AT	2"	2"	370	225	207	157	258	108	258	108	152	8	
TECH-CP30A	2"	2"	380	235	215	167	278	110	278	110	165	8	
TECH-CP30AT	2"	2"	380	235	215	167	278	110	278	110	165	8	

## Pump Selection Chart

Model	Power		Phase	Inlet / Outlet	Max. Flow (lpm)	Max. Head (m)	Max. Suction (m)
	KW	HP					
TECH-CP15A	1.1	1.5	1 Phase	2" x 2"	460	20	8
TECH-CP20A	1.5	2		2" x 2"	500	23	8
TECH-CP30A	2.2	3		2" x 2"	500	32	8
TECH-CP20AT	1.5	2	3 Phase	2" x 2"	500	23	8
TECH-CP30AT	2.2	3		2" x 2"	500	32	8